

### I. Function Characteristics

LCT-LX150 line amplifier is used in CATV system to amplify and distribute the user's signal or used in lateral as extending amplifier. LX150 amplifier adopts linear electric with the advantages such as wide range of input voltage stabilization of output voltage reliable capability etc. The amplifier adopts aluminous material crust, it has good heat dispelling.

LX150 line amplifier installed 0-20dB adjustable equalizer and attenuator inside, they make the slope and gain adjustable. The amplifier has -20dB input and output test point, they make the user debugs expediently.

### II. Main Principle Block

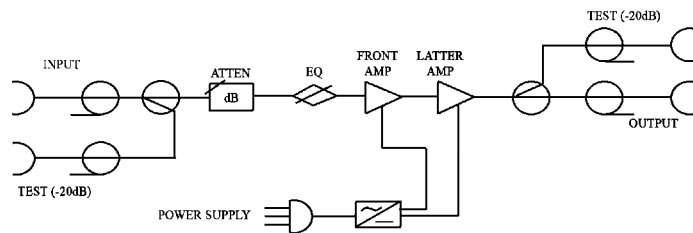

### III. Main Capability Parameters

NUM.	Items	Unit	Parameters	Remark
			LX150	
1	Frequency Range	MHz	47-862	
2	Gain	dB	40 ± 2	
3	Reflection Loss	dB	≥ 8	
4	Flatness	dB	± 1	
5	Noise Coefficient	dB	≤ 8	
6	GSO	dB	≥ 58	
7	CTB	dB	≥ 58	
8	Power Supply	V	220 ± 15%	50-60Hz
9	Crust Size	mm	194X132X52	
10	Interface Form		F75-ZY3B	
11	Impedance	Ω	75	
12	Power Expending	W	≤ 6	

### IV. Fixing Method

The amplifier crust has fixing holes, so it can be fixup at the required place. The fixing size as the picture following:

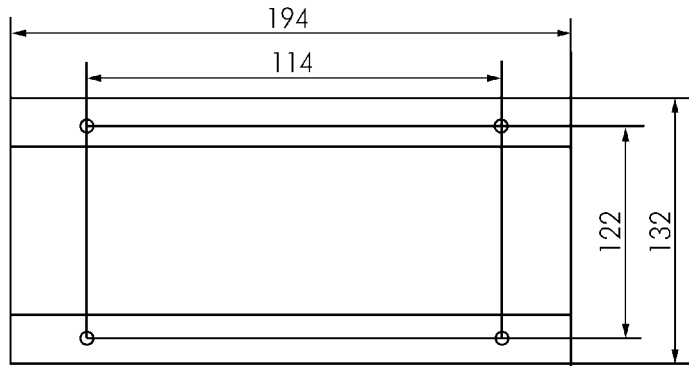

### V. Using Method

The amplifier panel has the place of adjustable gain and slope. You can adjust the attenuation knob to the necessary place according to the needed system power level and slope.

### VI. Maintenance Introduction

Hitch Phenomenon	Cause	Disposal Method
Power indicator light is not lighted.	Check if the fuse is bad.	Change the fuse
No output level	If the input and output connector are all right	Joint the connectors again
Not enough output level	Too much attenuation of attenuator	Adjust attenuator

### VII. Security Requirement introduction

LX150 amplifier is according with the relative provision of nation security standard GB8898-88, please the user observes without fail the following security notice proceeding:

- (1)LX150 amplifier must be supplied by 60V line power supply or 220V city power.
- (2)The inside of the amplifier is not allowed to exist any eyewinkers.